

LEGEND	
EXISTING/PROPOSED BUILDING - PHASE 1	
EXISTING/PROPOSED BUILDING - PHASE 2	
EXISTING/PROPOSED BUILDING - PHASE 3	
EXISTING/PROPOSED BUILDING - PHASE 4	
PROPOSED BUILDING - PHASE 5	
EXISTING BUILDING - PHASE 6	
PROPOSED BUILDING - PHASE 7	
PROPOSED BUILDING - PHASE 8	
EXISTING BUILDING - PHASE 9	
EXISTING SANITARY SEWER LINE	
PROPOSED SANITARY SEWER LINE - PHASE 1	
PROPOSED SANITARY FORCE MAIN - PHASE 1	
PROPOSED SEWER DEMOLITION - PHASE 1	
PROPOSED SANITARY SEWER LINE - FUTURE	
EXISTING SANITARY MANHOLE	
PROPOSED DIRECTIONAL BORING - PHASE 1	
PROPOSED SANITARY SEWER PIPE CLOSURE	
EXISTING POTABLE WATER LINE	
PROPOSED POTABLE WATER LINE - FUTURE	
EXISTING RAW WATER LINE	
PROPOSED WATER LINE DEMOLITION - PHASE 1	
EXISTING WATER VALVE	
EXISTING FIRE HYDRANT	
EXISTING PROPERTY LINE	
EXISTING WETLAND LINE	

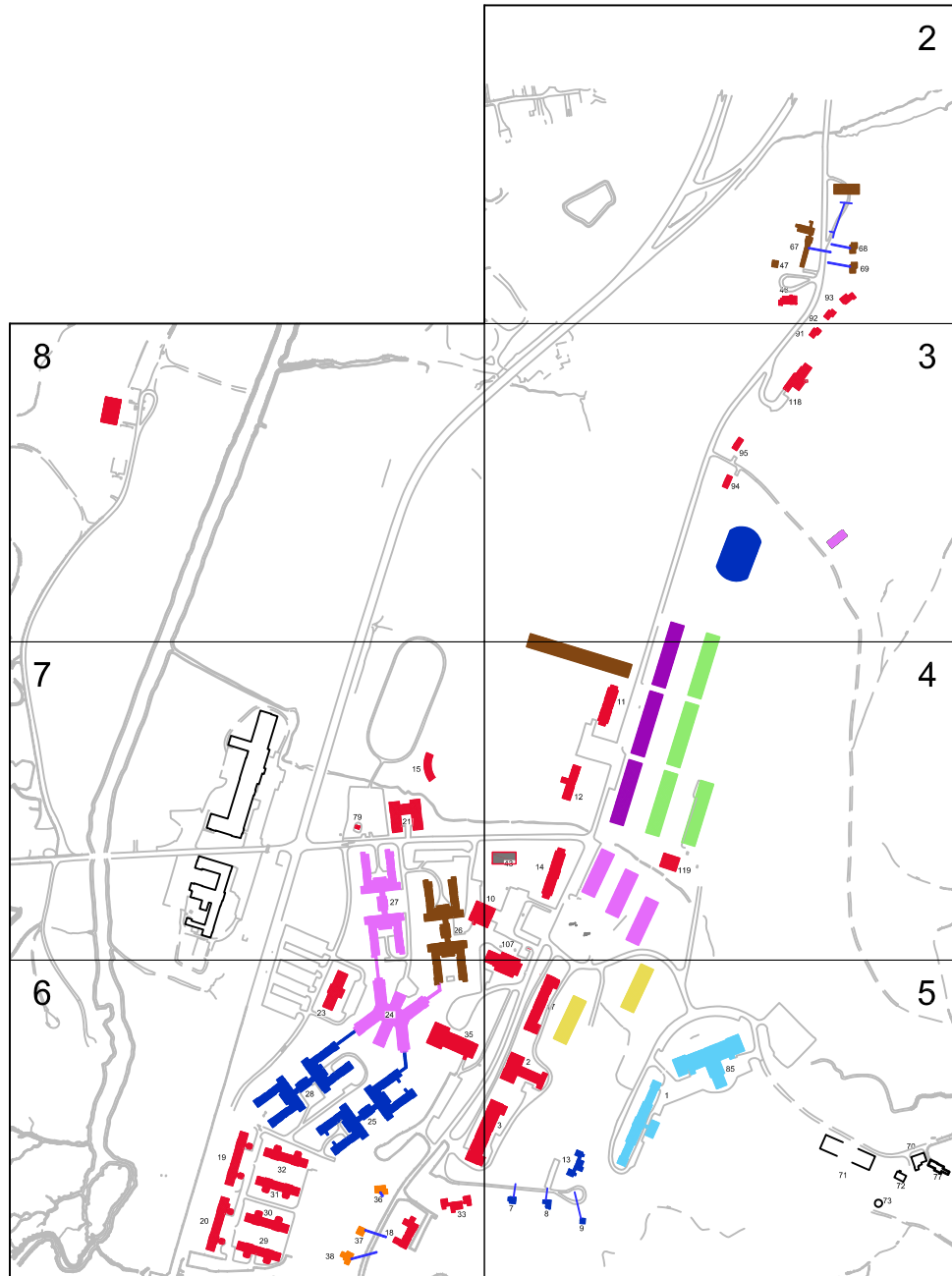

KEY PLAN

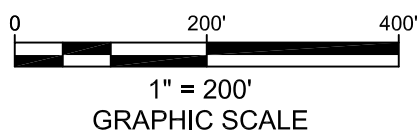

DATE	REVISION

ENGINEERING, DESIGN, & PLANS PREPARED BY:  
**RENNIA ENGINEERING DESIGN, PLLC**  
CIVIL • ENVIRONMENTAL • STRUCTURAL  
6 Dover Village Plaza, Suite 5, P.O. Box 400, Dover Plains, NY 12522  
Tel: (845) 877-0555 Fax: (845) 877-0556  
Copyright 2016, All Rights Reserved  
IT IS A VIOLATION OF NEW YORK STATE EDUCATION LAW FOR ANY PERSON TO ALTER THESE PLANS, SPECIFICATIONS OR REPORTS IN ANY WAY, UNLESS ACTING UNDER THE DIRECTION OF A LICENSED PROFESSIONAL ENGINEER.

DOVER GREENS							
TOWN OF DOVER				DUTCHESS COUNTY, NY			
OVERALL WATER DISTRIBUTION AND SEWAGE COLLECTION SYSTEMS							
DATE	SCALE	DESIGNED BY	DRAWN BY	CHECKED BY	JOB NO.	SHEET NO.	
7/19/2016	1"=200'	RAR	RED	RAR	13-019	1 of 8	



KEY OF SHEETS

		2
8		3
7		4
6		5

LEGEND

EXISTING/PROPOSED BUILDING - PHASE 1		
EXISTING/PROPOSED BUILDING - PHASE 2		
EXISTING/PROPOSED BUILDING - PHASE 3		
EXISTING/PROPOSED BUILDING - PHASE 4		
PROPOSED BUILDING - PHASE 5		
EXISTING BUILDING - PHASE 6		
PROPOSED BUILDING - PHASE 7		
PROPOSED BUILDING - PHASE 8		
EXISTING BUILDING - PHASE 9		
EXISTING SANITARY SEWER LINE		
EXISTING SANITARY SEWER LINE - PHASE 1		
PROPOSED SANITARY SEWER LINE - PHASE 1		
PROPOSED SANITARY SEWER LINE - FUTURE		
PROPOSED SEWER DEMOLITION - PHASE 1		
PROPOSED SANITARY FORCE MAIN - FUTURE		
EXISTING SANITARY MANHOLE		
PROPOSED SANITARY SEWER PIPE CLOSURE		
EXISTING POTABLE WATER LINE		
EXISTING RAIN WATER LINE		
PROPOSED WATER LINE DEMOLITION - PHASE 1		
EXISTING WATER VALVE		
EXISTING FIRE HYDRANT		
EXISTING PROPERTY LINE		
EXISTING WETLAND LINE		

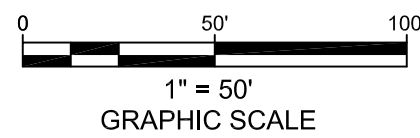
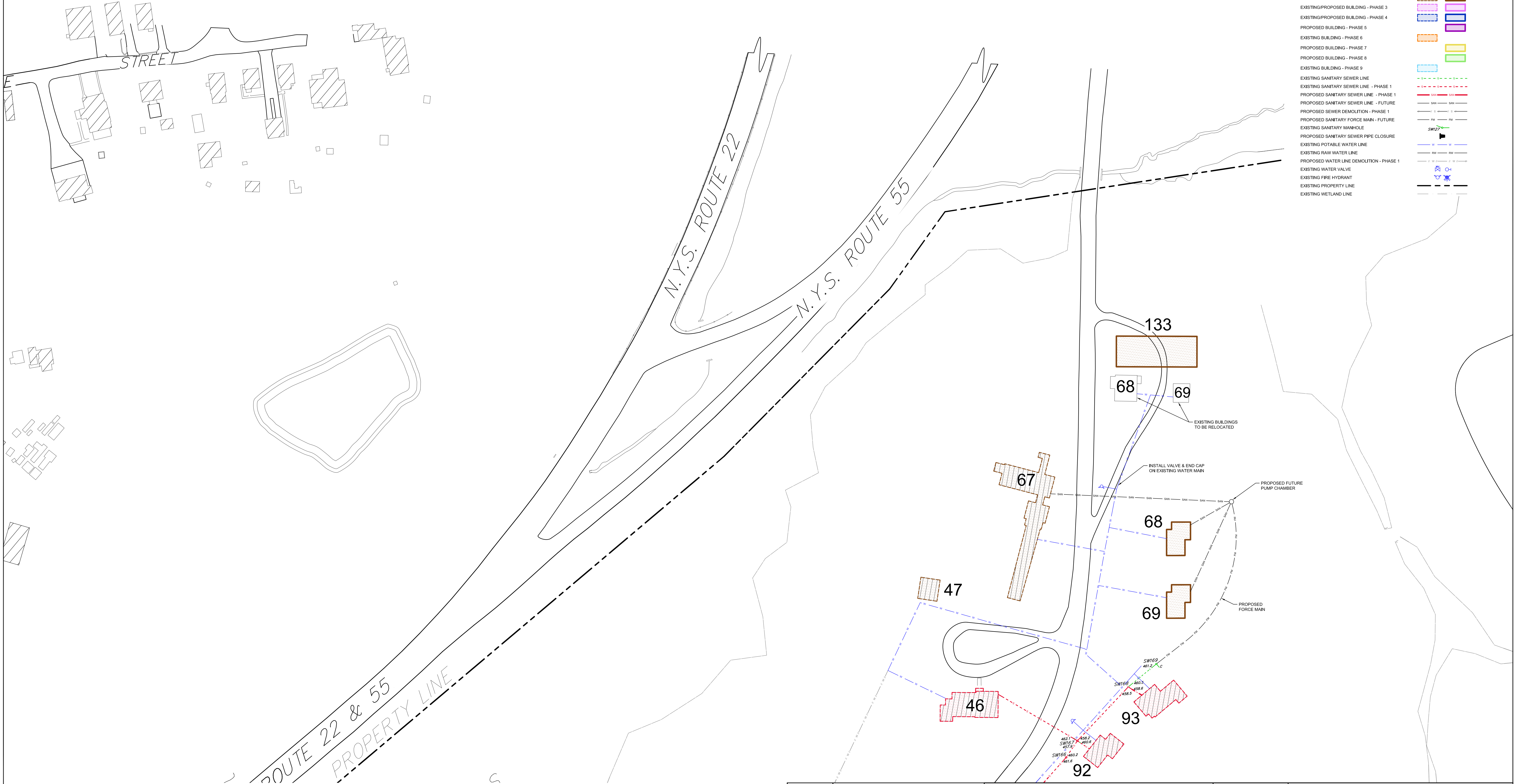

DATE	REVISION

ENGINEERING, DESIGN, & PLANS PREPARED BY:  
**RENNIA ENGINEERING DESIGN, PLLC**  
CIVIL • ENVIRONMENTAL • STRUCTURAL  
6 Dover Village Plaza, Suite 5, P.O. Box 400, Dover Plains, NY 12522  
Tel: (845) 877-0555 Fax: (845) 877-0556  
Copyright 2016, All Rights Reserved  
IT IS A VIOLATION OF NEW YORK STATE EDUCATION LAW FOR ANY PERSON TO ALTER THESE PLANS, SPECIFICATIONS OR REPORTS IN ANY WAY, UNLESS ACTING UNDER THE DIRECTION OF A LICENSED PROFESSIONAL ENGINEER.

DOVER GREENS				
TOWN OF DOVER DUTCHESS COUNTY, NY				
WATER DISTRIBUTION AND SEWAGE COLLECTION SYSTEMS				
DATE	SCALE	DESIGNED BY	CHECKED BY	JOB NO.
7/19/18	1"=50'	RAR	RED	13-019
SHEET NO.				2 of 8







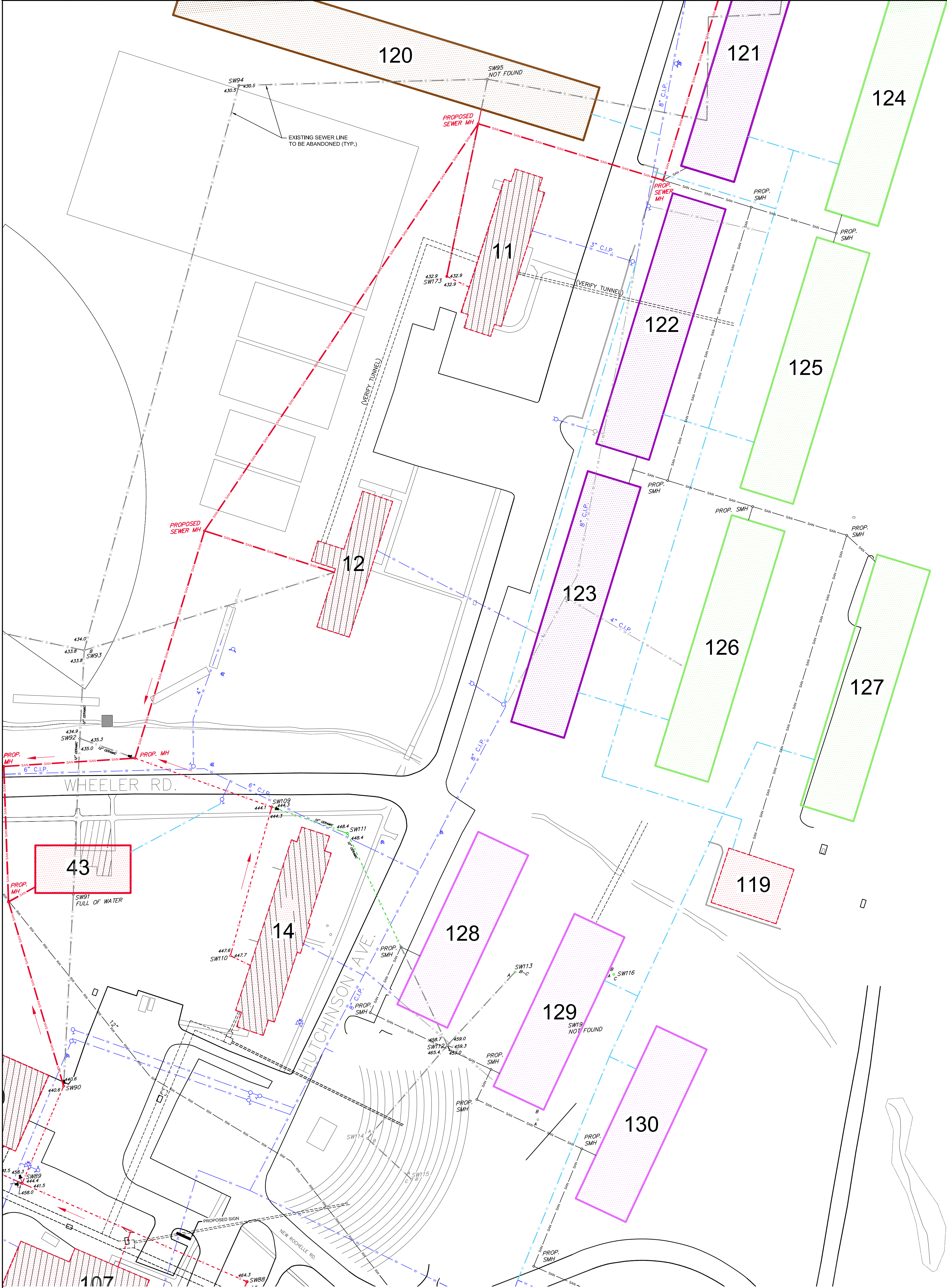

KEY OF SHEETS

		2
8		3
7		4
6		5

LEGEND

- EXISTING/PROPOSED BUILDING - PHASE 1
- EXISTING/PROPOSED BUILDING - PHASE 2
- EXISTING/PROPOSED BUILDING - PHASE 3
- EXISTING/PROPOSED BUILDING - PHASE 4
- PROPOSED BUILDING - PHASE 5
- EXISTING BUILDING - PHASE 6
- PROPOSED BUILDING - PHASE 7
- PROPOSED BUILDING - PHASE 8
- EXISTING BUILDING - PHASE 9
- EXISTING SANITARY SEWER LINE
- EXISTING SANITARY SEWER LINE - PHASE 1
- PROPOSED SANITARY SEWER LINE - PHASE 1
- PROPOSED SEWER DEMOLITION - PHASE 1
- PROPOSED SANITARY SEWER LINE - FUTURE
- EXISTING SANITARY MANHOLE
- PROPOSED SANITARY SEWER PIPE CLOSURE
- EXISTING POTABLE WATER LINE
- PROPOSED WATER LINE DEMOLITION - PHASE 1
- PROPOSED POTABLE WATER LINE - FUTURE
- EXISTING RAW WATER LINE
- EXISTING WATER VALVE
- EXISTING FIRE HYDRANT
- EXISTING PROPERTY LINE
- EXISTING WETLAND LINE

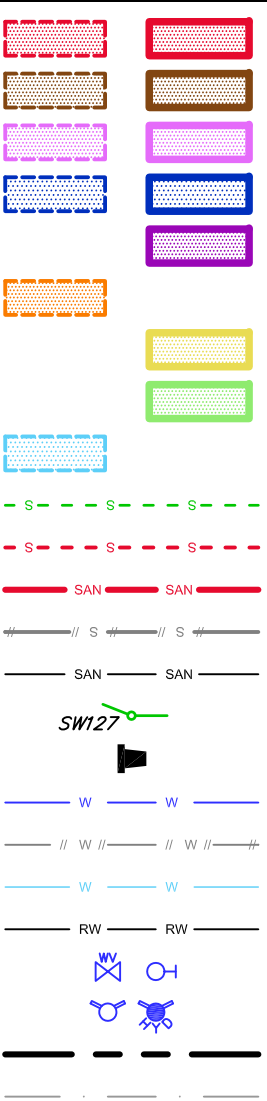

DATE	REVISION

ENGINEERING, DESIGN, & PLANS PREPARED BY:  
**RENNIA ENGINEERING DESIGN, PLLC**  
CIVIL • ENVIRONMENTAL • STRUCTURAL  
9 Dover Village Plaza, Suite 5, P.O. Box 400, Dover Plains, NY 12522  
Tel: (845) 877-0555 Fax: (845) 877-0556  
Copyright 2016, All Rights Reserved  
IT IS A VIOLATION OF NEW YORK STATE EDUCATION LAW FOR ANY PERSON TO ALTER THESE PLANS, SPECIFICATIONS OR REPORTS IN ANY WAY, UNLESS ACTING UNDER THE DIRECTION OF A LICENSED PROFESSIONAL ENGINEER.

DOVER GREENS

TOWN OF DOVER	DUTCHESS COUNTY, NY					
<div style="border: 1px solid black; padding: 10px 0 0 0; margin: 0 auto; width: 90%;">WATER DISTRIBUTION AND SEWAGE COLLECTION SYSTEMS</div>						
DATE	SCALE	DESIGNED BY	DRAWN BY	CHECKED BY	JOB NO.	SHEET NO.
7/19/16	1"=50'	RAR	RED	RAR	13-019	4 of 8



KEY OF SHEETS

		2
8		3
7		4
6		5

LEGEND

EXISTING/PROPOSED BUILDING - PHASE 1	
EXISTING/PROPOSED BUILDING - PHASE 2	
EXISTING/PROPOSED BUILDING - PHASE 3	
EXISTING/PROPOSED BUILDING - PHASE 4	
PROPOSED BUILDING - PHASE 5	
EXISTING BUILDING - PHASE 6	
PROPOSED BUILDING - PHASE 7	
PROPOSED BUILDING - PHASE 8	
EXISTING BUILDING - PHASE 9	
EXISTING SANITARY SEWER LINE	
EXISTING SANITARY SEWER LINE - PHASE 1	
PROPOSED SANITARY SEWER LINE - PHASE 1	
PROPOSED SEWER DEMOLITION - PHASE 1	
EXISTING SANITARY MANHOLE	
PROPOSED SANITARY SEWER PIPE CLOSURE	
EXISTING POTABLE WATER LINE	
EXISTING RAW WATER LINE	
PROPOSED WATER LINE DEMOLITION - PHASE 1	
EXISTING WATER VALVE	
EXISTING FIRE HYDRANT	
EXISTING PROPERTY LINE	
EXISTING WETLAND LINE	

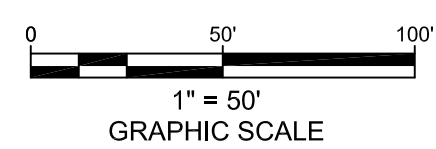
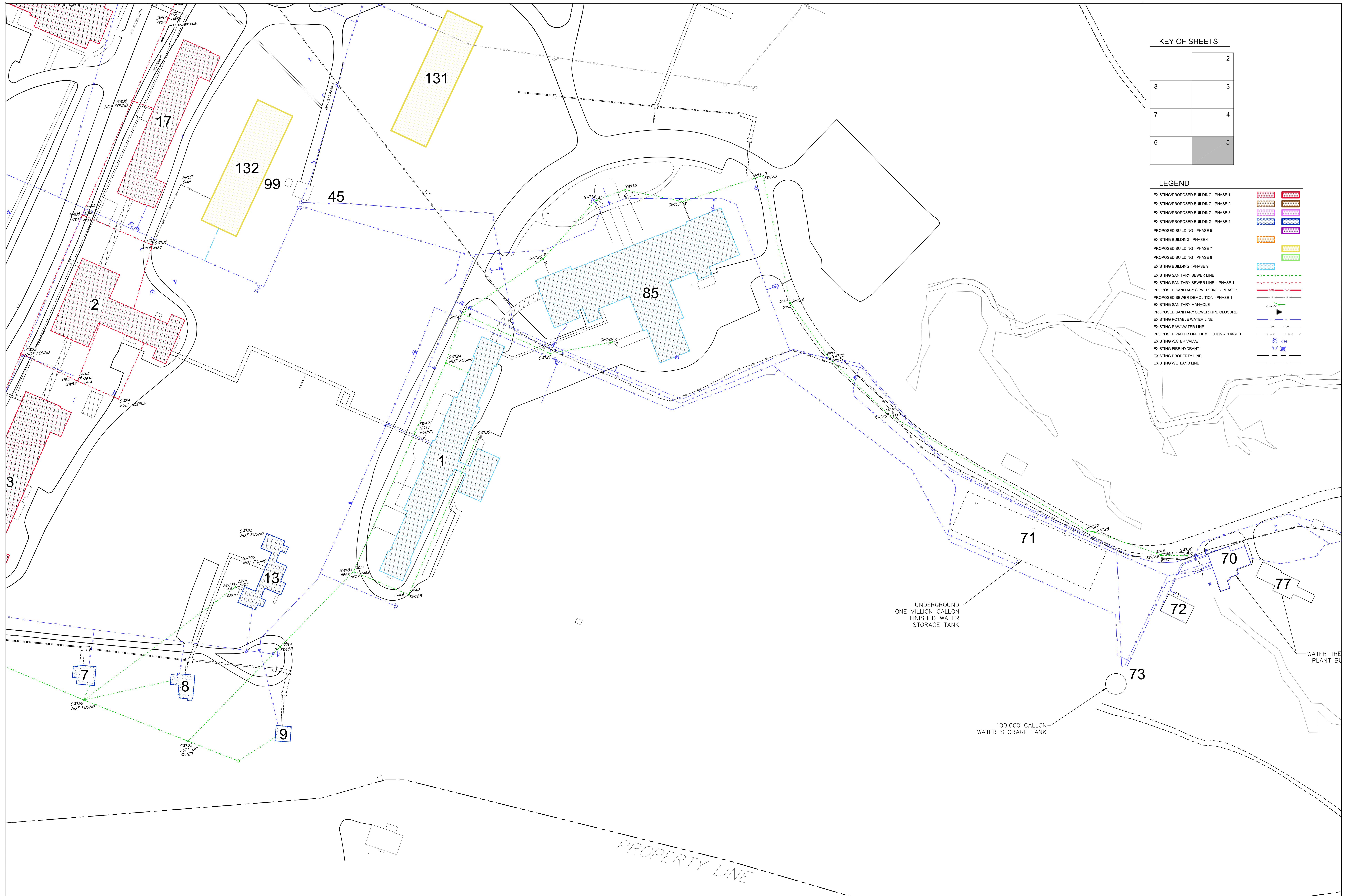

DATE	REVISION

ENGINEERING, DESIGN, & PLANS PREPARED BY:  
**RENNIA ENGINEERING DESIGN, PLLC**  
CIVIL • ENVIRONMENTAL • STRUCTURAL  
6 Dover Village Plaza, Suite 5, P.O. Box 400, Dover Plains, NY 12522  
Tel: (845) 877-0555 Fax: (845) 877-0556  
Copyright 2016, All Rights Reserved  
IT IS A VIOLATION OF NEW YORK STATE EDUCATION LAW FOR ANY PERSON TO ALTER THESE PLANS, SPECIFICATIONS OR REPORTS IN ANY WAY, UNLESS ACTING UNDER THE DIRECTION OF A LICENSED PROFESSIONAL ENGINEER.

DOVER GREENS						
TOWN OF DOVER				DUTCHESS COUNTY, NY		
WATER DISTRIBUTION AND SEWAGE COLLECTION SYSTEMS						
DATE	SCALE	DESIGNED BY	DRAWN BY	CHECKED BY	JOB NO.	SHEET NO.
7/19/16	1"=50'	RAR	RED	RAR	13-019	5 of 8



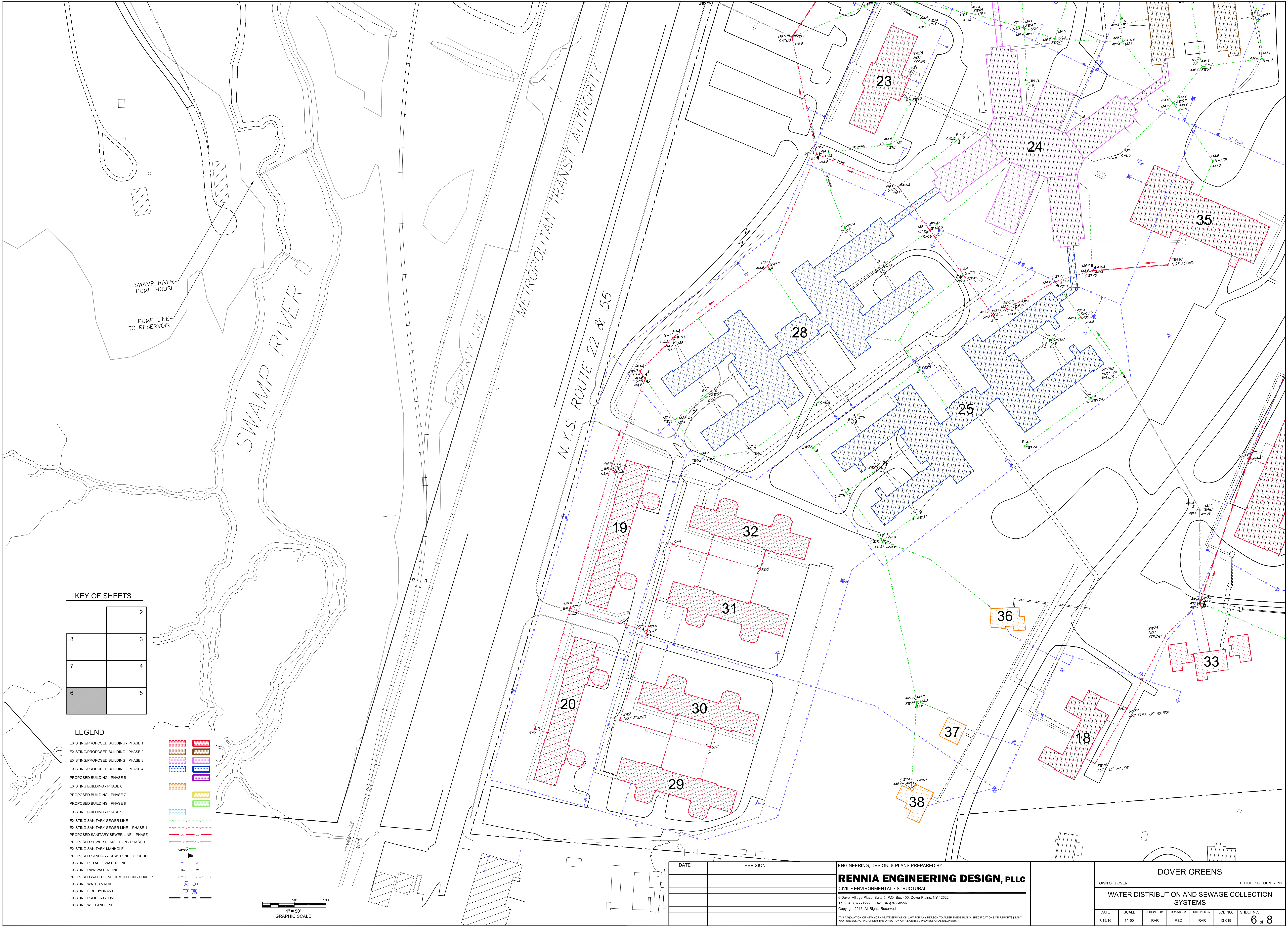

KEY OF SHEETS

			2
8			3
7			4
6			5

LEGEND

- EXISTING/PROPOSED BUILDING - PHASE 1
- EXISTING/PROPOSED BUILDING - PHASE 2
- EXISTING/PROPOSED BUILDING - PHASE 3
- EXISTING/PROPOSED BUILDING - PHASE 4
- PROPOSED BUILDING - PHASE 5
- EXISTING BUILDING - PHASE 6
- PROPOSED BUILDING - PHASE 7
- PROPOSED BUILDING - PHASE 8
- EXISTING BUILDING - PHASE 9
- EXISTING SANITARY SEWER LINE
- EXISTING SANITARY SEWER LINE - PHASE 1
- PROPOSED SANITARY SEWER LINE - PHASE 1
- PROPOSED SEWER DEMOLITION - PHASE 1
- EXISTING SANITARY MANHOLE
- PROPOSED SANITARY SEWER PIPE CLOSURE
- EXISTING POTABLE WATER LINE
- EXISTING RAW WATER LINE
- PROPOSED WATER LINE DEMOLITION - PHASE 1
- EXISTING WATER VALVE
- EXISTING FIRE HYDRANT
- EXISTING PROPERTY LINE
- EXISTING WETLAND LINE

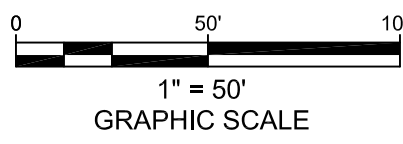
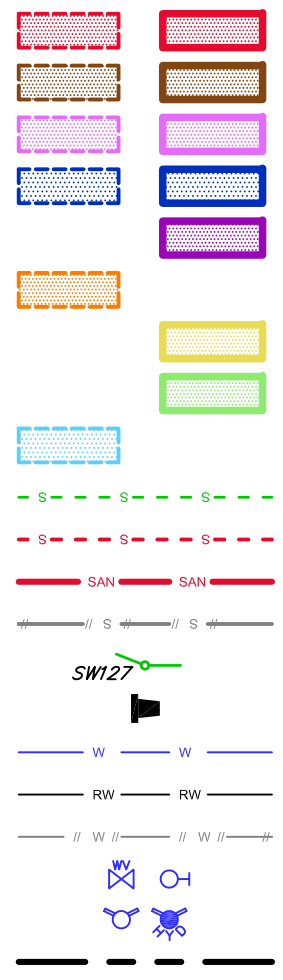

DATE	REVISION

ENGINEERING, DESIGN, & PLANS PREPARED BY:  
**RENNIA ENGINEERING DESIGN, PLLC**  
CIVIL • ENVIRONMENTAL • STRUCTURAL  
9 Dover Village Plaza, Suite 5, P.O. Box 400, Dover Plains, NY 12022  
Tel: (845) 877-0555 Fax: (845) 877-0556  
Copyright 2016, All Rights Reserved  
IT IS A VIOLATION OF NEW YORK STATE EDUCATION LAW FOR ANY PERSON TO ALTER THESE PLANS, SPECIFICATIONS OR REPORTS IN ANY WAY, UNLESS ACTING UNDER THE DIRECTION OF A LICENSED PROFESSIONAL ENGINEER.

TOWN OF DOVER						DUTCHESS COUNTY, NY	
DOVER GREENS							
WATER DISTRIBUTION AND SEWAGE COLLECTION SYSTEMS							
DATE	SCALE	DESIGNED BY	CHECKED BY	JOB NO.	SHEET NO.		
7/19/18	1"=50'	RAR	RED	RAR	13-019	6 of 8	



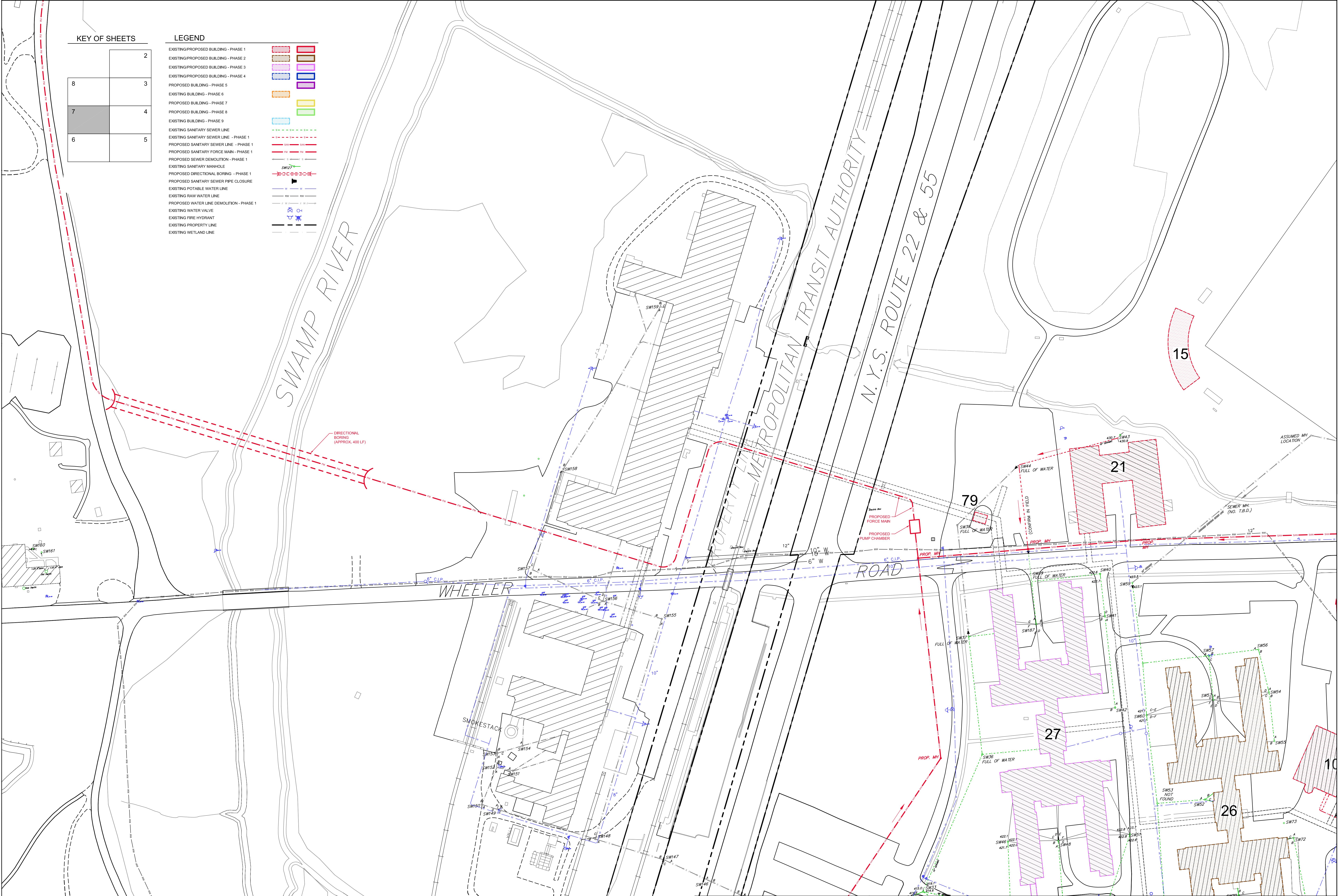

KEY OF SHEETS

8	3
7	4
6	5

LEGEND

- EXISTING/PROPOSED BUILDING - PHASE 1
- EXISTING/PROPOSED BUILDING - PHASE 2
- EXISTING/PROPOSED BUILDING - PHASE 3
- EXISTING/PROPOSED BUILDING - PHASE 4
- PROPOSED BUILDING - PHASE 5
- EXISTING BUILDING - PHASE 6
- PROPOSED BUILDING - PHASE 7
- PROPOSED BUILDING - PHASE 8
- EXISTING BUILDING - PHASE 9
- EXISTING SANITARY SEWER LINE
- EXISTING SANITARY SEWER LINE - PHASE 1
- PROPOSED SANITARY SEWER LINE - PHASE 1
- PROPOSED SANITARY FORCE MAIN - PHASE 1
- PROPOSED SEWER DEMOLITION - PHASE 1
- EXISTING SANITARY MANHOLE
- PROPOSED DIRECTIONAL BORING - PHASE 1
- PROPOSED SANITARY SEWER PIPE CLOSURE
- EXISTING POTABLE WATER LINE
- EXISTING RAW WATER LINE
- PROPOSED WATER LINE DEMOLITION - PHASE 1
- EXISTING WATER VALVE
- EXISTING FIRE HYDRANT
- EXISTING PROPERTY LINE
- EXISTING WETLAND LINE

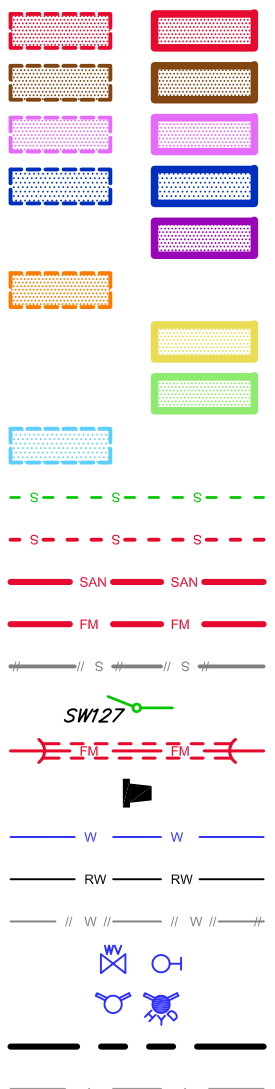

N.Y.S. ROUTE 22 & 55

PROPERTY METROPOLITAN TRANSIT AUTHORITY

WHEELER ROAD

SWAMP RIVER

15

21

79

27

26

10

DATE	REVISION

ENGINEERING, DESIGN, & PLANS PREPARED BY:  
**RENNIA ENGINEERING DESIGN, PLLC**  
CIVIL • ENVIRONMENTAL • STRUCTURAL  
9 Dover Village Plaza, Suite 5, P.O. Box 400, Dover Plains, NY 12522  
Tel: (845) 877-0555 Fax: (845) 877-0556  
Copyright 2016, All Rights Reserved  
IT IS A VIOLATION OF NEW YORK STATE EDUCATION LAW FOR ANY PERSON TO ALTER THESE PLANS, SPECIFICATIONS OR REPORTS IN ANY WAY, UNLESS ACTING UNDER THE DIRECTION OF A LICENSED PROFESSIONAL ENGINEER.

DOVER GREENS

TOWN OF DOVERDUTCHESS COUNTY, NY

WATER DISTRIBUTION AND SEWAGE COLLECTION  
SYSTEMS

DATE	SCALE	DESIGNED BY	DRAWN BY	CHECKED BY	JOB NO.	SHEET NO.
7/19/16	1"=50'	RAR	RED	RAR	13-019	7 of 8

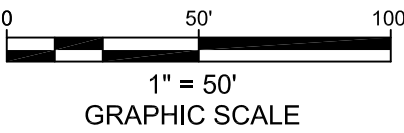



KEY OF SHEETS

		2
8		3
7		4
6		5

LEGEND

- EXISTING/PROPOSED BUILDING - PHASE 1  
EXISTING/PROPOSED BUILDING - PHASE 2  
EXISTING/PROPOSED BUILDING - PHASE 3  
EXISTING/PROPOSED BUILDING - PHASE 4  
PROPOSED BUILDING - PHASE 5  
EXISTING BUILDING - PHASE 6  
PROPOSED BUILDING - PHASE 7  
PROPOSED BUILDING - PHASE 8  
EXISTING BUILDING - PHASE 9  
EXISTING SANITARY SEWER LINE  
EXISTING SANITARY SEWER LINE - PHASE 1  
PROPOSED SANITARY SEWER LINE - PHASE 1  
PROPOSED SANITARY FORCE MAIN - PHASE 1  
PROPOSED SEWER DEMOLITION - PHASE 1  
EXISTING SANITARY MANHOLE  
PROPOSED SANITARY SEWER PIPE CLOSURE  
EXISTING POTABLE WATER LINE  
EXISTING RAW WATER LINE  
PROPOSED WATER LINE DEMOLITION - PHASE 1  
EXISTING WATER VALVE  
EXISTING FIRE HYDRANT  
EXISTING PROPERTY LINE  
EXISTING WETLAND LINE

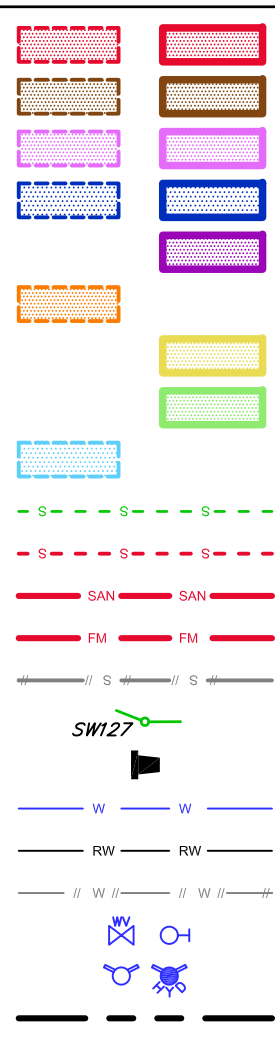

PROPOSED WWTP

TANKS

SW171  
FULL OF WATER

SW172  
FULL OF SLUDGE

WASTEWATER  
TREATMENT  
PLANT

SWAMP RIVER

WETLANDS

PROPERTY LINE

METROPOLITAN

WETLANDS

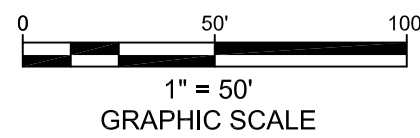

DATE	REVISION

ENGINEERING, DESIGN, & PLANS PREPARED BY:  
**RENNIA ENGINEERING DESIGN, PLLC**  
CIVIL • ENVIRONMENTAL • STRUCTURAL  
6 Dover Village Plaza, Suite 5, P.O. Box 400, Dover Plains, NY 12522  
Tel: (845) 877-0555 Fax: (845) 877-0556  
Copyright 2016, All Rights Reserved  
IT IS A VIOLATION OF NEW YORK STATE EDUCATION LAW FOR ANY PERSON TO ALTER THESE PLANS, SPECIFICATIONS OR REPORTS IN ANY WAY, UNLESS ACTING UNDER THE DIRECTION OF A LICENSED PROFESSIONAL ENGINEER.

DOVER GREENS					
TOWN OF DOVER			DUTCHESS COUNTY, NY		
WATER DISTRIBUTION AND SEWAGE COLLECTION SYSTEMS					
DATE	SCALE	DESIGNED BY	DRAWN BY	CHECKED BY	JOB NO. SHEET NO.
7/19/16	1"=50'	RAR	RED	RAR	13-019 8 of 8